



INSTALLATIONSHANDBUCH

Club 322F

Club 3412T

Club 422F

Club 522F

Club 602C

Club 602CTP

Club 620F

Club 622

Club 6422F

Club 8622F

Club 9632

Club 322F

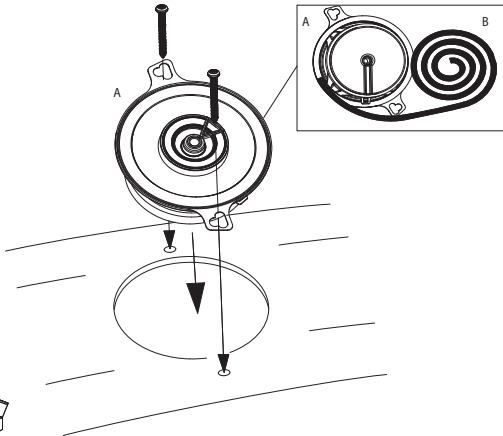
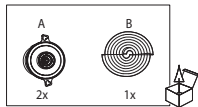
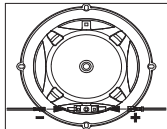

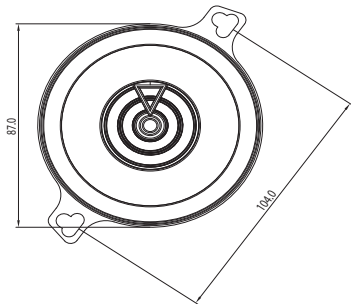
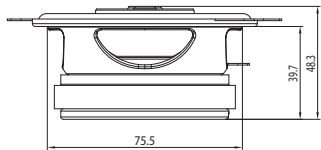

Technische Daten

- Typ: 3,5" (87 mm)-Zwei-Wege-Autolautsprecher
- Nennbelastbarkeit: 25 W RMS, 75 W Spitze
- Empfindlichkeit (bei 2,83 V): 89 dB
- Frequenzgang: 90 Hz – 20 kHz
- Nennimpedanz: 3,0 Ohm

Thiele-Small-Parameter

- BL (Tm): 2,873
- DCR (ohms): 2,26
- Mms (g): 3,723
- Sd (cm²): 44,18
- Cms (μm/N): 0,491
- Vas (l): 1,3574
- Fs (Hz): 117,7
- Qes: 0,755
- Qms: 7,777
- Qts: 0,688
- Crossover Point: 4kHz

Club 3412T

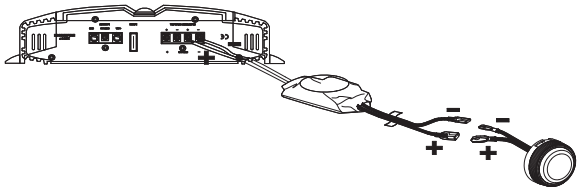
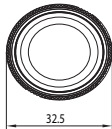
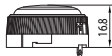

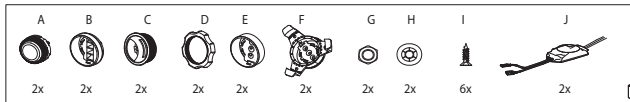
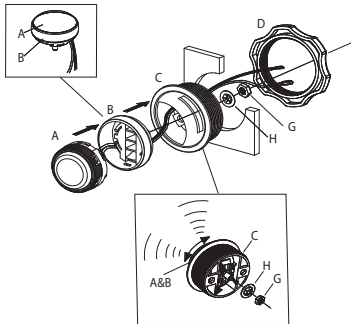
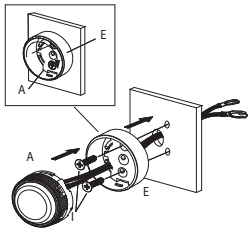

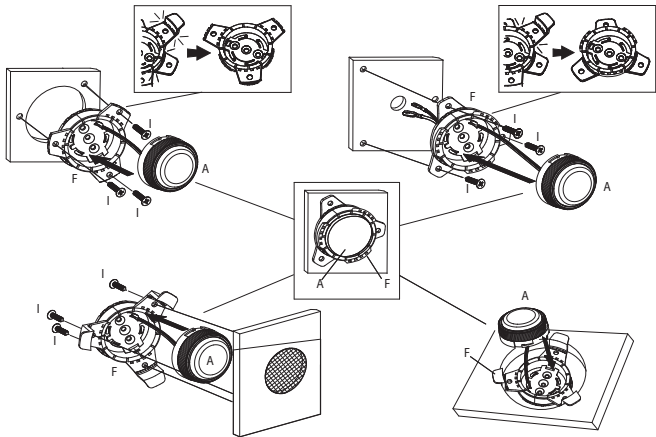

Technische Daten

- Typ: 0,75" (19 mm)-Hochtönkalotte mit Seidenmembran
- Nennbelastbarkeit: 50 W RMS, 150 W Spitze
- Empfindlichkeit (bei 2,83 V): 92 dB
- Frequenzgang: 3k Hz – 20 kHz
- Nennimpedanz: 3,0 Ohm

Club 422F

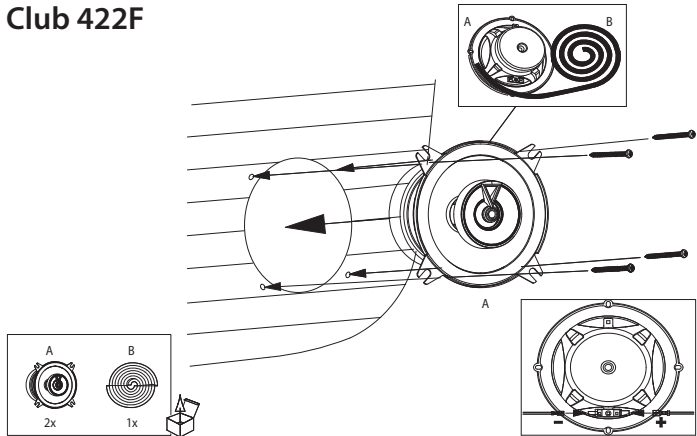

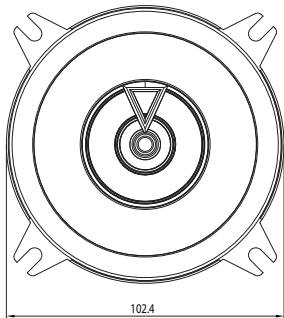
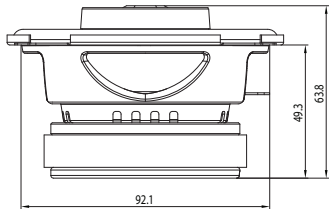

Technische Daten

- Typ: 4" (100 mm)-Zwei-Wege-Autolautsprecher
- Nennbelastbarkeit: 35 W RMS, 105 W Spitze
- Empfindlichkeit (bei 2,83 V): 90 dB
- Frequenzgang: 75 Hz – 20 kHz
- Nennimpedanz: 3,0 Ohm

Thiele-Small-Parameter

- BL (Tm): 3,783
- DCR (ohms): 2,46
- Mms (g): 6,608
- Sd (cm²): 63,62
- Cms (μm/N): 0,750
- Vas (l): 4,2937
- Fs (Hz): 71,5
- Qes: 0,510
- Qms: 6,495
- Qts: 0,473
- Crossover Point: 3kHz

Club 522F

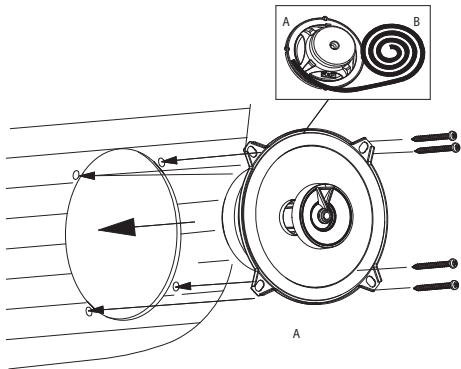
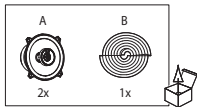
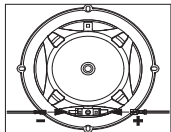

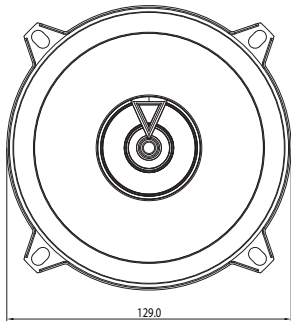
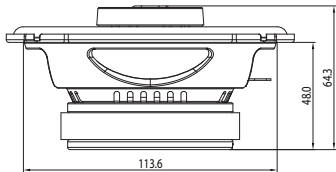

Technische Daten

- Typ: 5,25" (130 mm)-Zwei-Wege-Autolautsprecher
- Nennbelastbarkeit: 45 W RMS, 135 W Spitze
- Empfindlichkeit (bei 2,83 V): 91 dB
- Frequenzgang: 75 Hz – 20 kHz
- Nennimpedanz: 3,0 Ohm

Thiele-Small-Parameter

- BL (Tm): 3,563
- DCR (ohms): 2,24
- Mms (g): 9,484
- Sd (cm²): 103,87
- Cms (µm/N): 0,274
- Vas (l): 4,1850
- Fs (Hz): 98,7
- Qes: 1,036
- Qms: 8,608
- Qts: 0,925
- Crossover Point: 3kHz

Club 602C

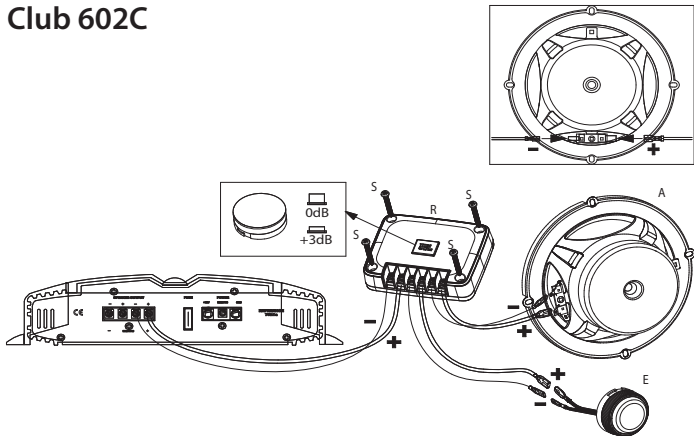

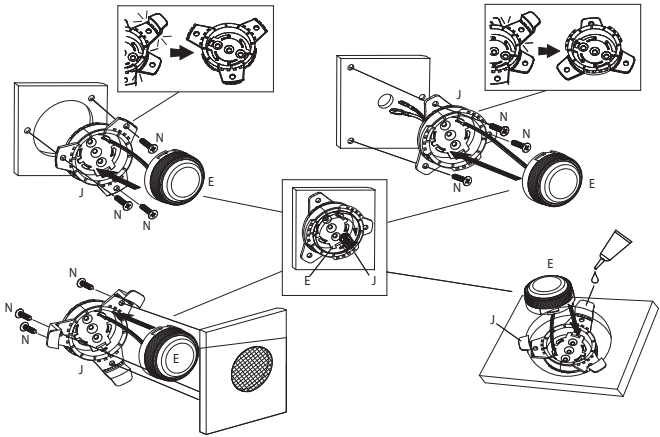

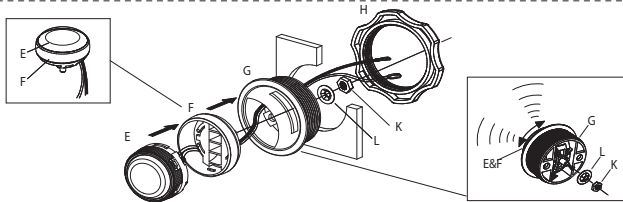
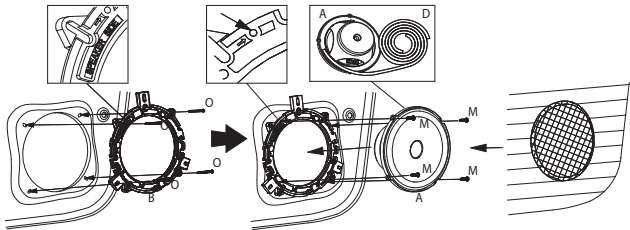

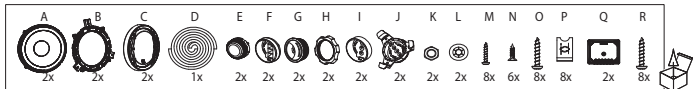
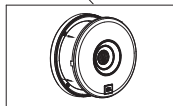
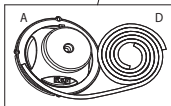
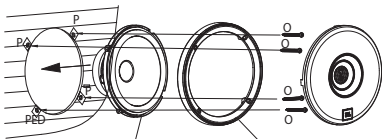
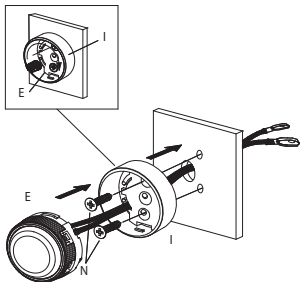

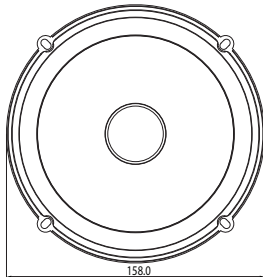
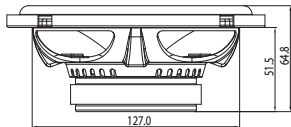
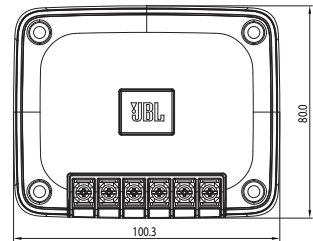

Technische Daten

- Typ: 6,5" (160 mm)-Zwei-Wege-Komponenten-Lautsprecher
- Nennbelastbarkeit: 70 W RMS, 210 W Spitze
- Empfindlichkeit (bei 2,83 V): 92 dB
- Frequenzgang: 55 Hz – 20 kHz
- Nennimpedanz: 3,0 Ohm

Thiele-Small-Parameter

- BL (Tm): 3,635
- DCR (ohms): 2,37
- Mms (g): 14,409
- Sd (cm²): 132,73
- Cms (μm/N): 0,257
- Vas (l): 6,4107
- Fs (Hz): 82,7
- Qes: 1,340
- Qms: 10,965
- Qts: 1,194
- Crossover Point: 5,5kHz

Club 602CTP

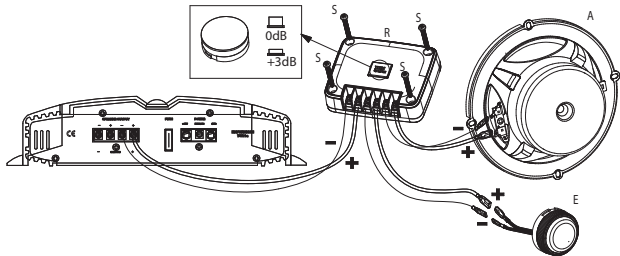
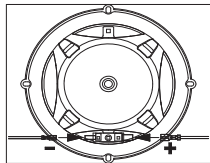

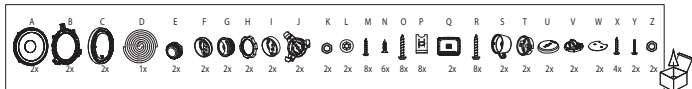
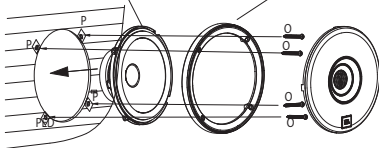
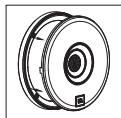
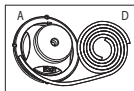
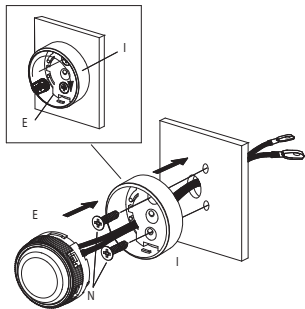

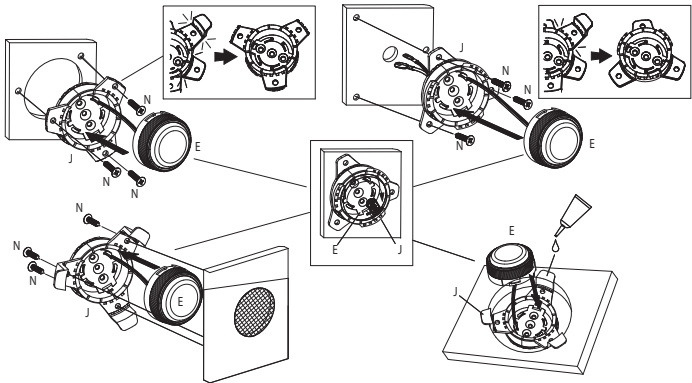

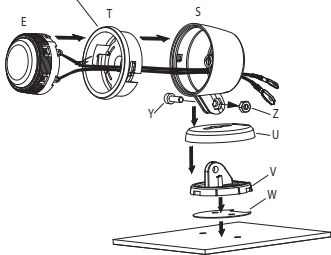
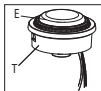
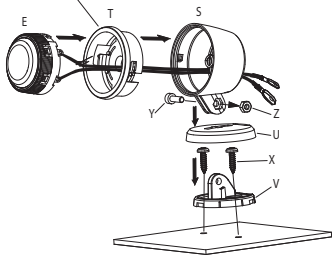
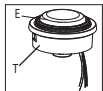

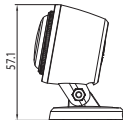
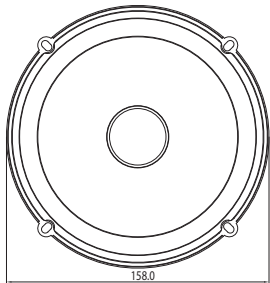
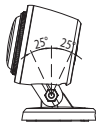
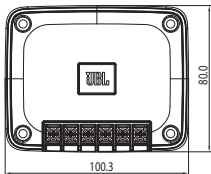
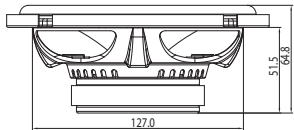

Technische Daten

- Typ: 6-1/2" (160 mm)-2-Wege-Komponentenlautsprechersystem mit Hochtöner-Aufsatz
- Nennbelastbarkeit: 70 W RMS, 210 W Spitze
- Empfindlichkeit (bei 2,83 V): 92 dB
- Frequenzgang: 55 Hz – 20 kHz
- Nennimpedanz: 3,0 Ohm

Thiele-Small-Parameter

- BL (Tm): 3,635
- DCR (ohms): 2,37
- Mms (g): 14,409
- Sd (cm²): 132,73
- Cms (µm/N): 0,257
- Vas (l): 6,4107
- Fs (Hz): 82,7
- Qes: 1,340
- Qms: 10,965
- Qts: 1,194
- Crossover Point: 5,5kHz

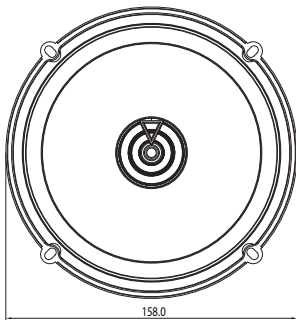
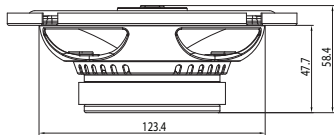

Technische Daten

- Typ: 6,5" (160 mm)-Zwei-Wege-Flachlautsprecher
- Nennbelastbarkeit: 55 W RMS, 165 W Spitze
- Empfindlichkeit (bei 2,83 V): 92 dB
- Frequenzgang: 55 Hz – 20 kHz
- Nennimpedanz: 3,0 Ohm

Thiele-Small-Parameter

- BL (Tm): 3,739
- DCR (ohms): 2,41
- Mms (g): 9,934
- Sd (cm²): 122,72
- Cms (μm/N): 0,278
- Vas (l): 5,9287
- Fs (Hz): 95,7
- Qes: 1,032
- Qms: 11,357
- Qts: 0,946
- Crossover Point: 4kHz

Club 622

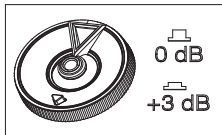
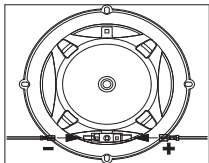

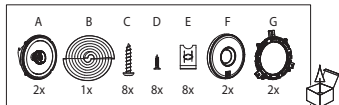
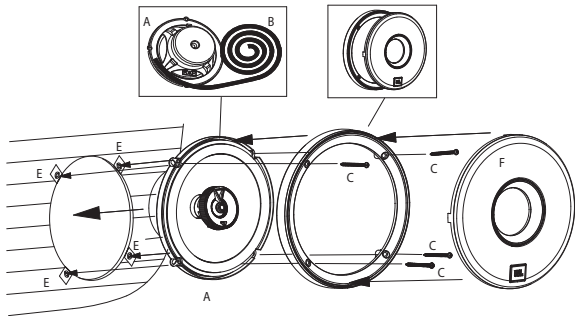

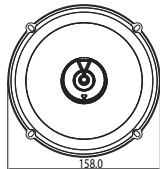
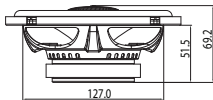
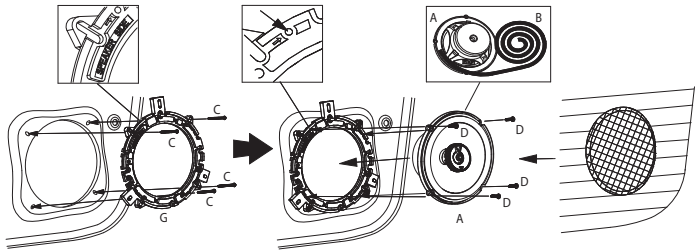

Technische Daten

- Typ: 6,5" (160 mm)-Zwei-Wege-Autolautsprecher, für eine optimale Soundqualität konstruiert.
- Nennbelastbarkeit: 60 W RMS, 180 W Spitze
- Empfindlichkeit (bei 2,83 V): 93 dB
- Frequenzgang: 48 Hz – 21 kHz
- Nennimpedanz: 3,0 Ohm

Thiele-Small-Parameter

- BL (Tm): 3,632
- DCR (ohms): 2,36
- Mms (g): 13,758
- Sd (cm²): 132,73
- Cms (µm/N): 0,378
- Vas (l): 9,4253
- Fs (Hz): 69,8
- Qes: 1,080
- Qms: 10,655
- Qts: 0,980
- Crossover Point: 3,5kHz

Club 6422F

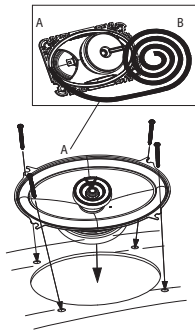
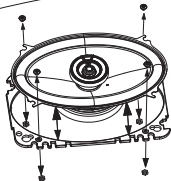
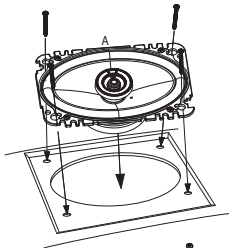
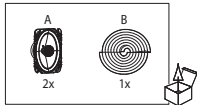
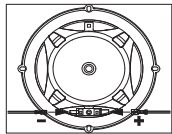

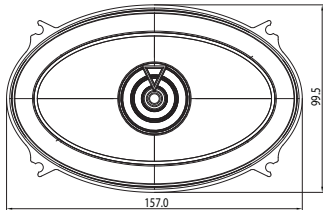
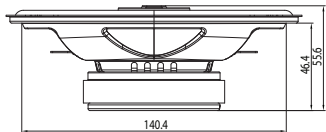

Technische Daten

- Typ: 4" x 6" (100 x 152 mm)-Zwei-Wege-Autolautsprecher,
- Nennbelastbarkeit: 40 W RMS, 120 W Spitze
- Empfindlichkeit (bei 2,83 V): 92 dB
- Frequenzgang: 75 Hz – 20 kHz
- Nennimpedanz: 3,0 Ohm

Thiele-Small-Parameter

- BL (Tm): 3,296
- DCR (ohms): 2,5
- Mms (g): 7,86
- Sd (cm²): 86,59
- Cms (µm/N): 0,245
- Vas (l): 2,5977
- Fs (Hz): 114,7
- Qes: 1,303
- Qms: 12,752
- Qts: 1,182
- Crossover Point: 3kHz

Club 8622F

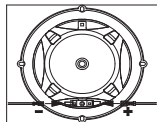
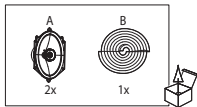
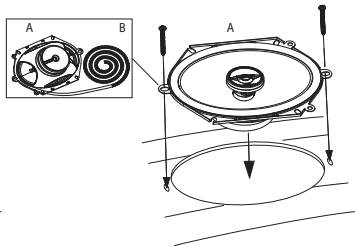
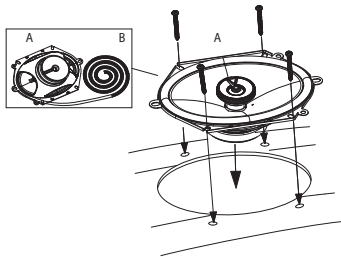

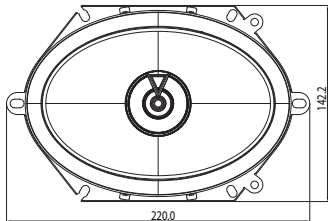
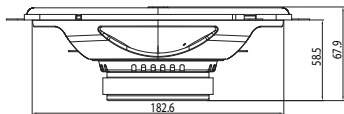

Technische Daten

- Typ: 6" x 8" (152 x 203 mm)-Zwei-Wege-Autolautsprecher, ohne Gitter
- Nennbelastbarkeit: 60 W RMS, 180 W Spitze
- Empfindlichkeit (bei 2,83 V): 93 dB
- Frequenzgang: 65 Hz – 20 kHz
- Nennimpedanz: 3,0 Ohm

Thiele-Small-Parameter

- BL (Tm): 3,785
- DCR (ohms): 2,39
- Mms (g): 17,718
- Sd (cm²): 165,13
- Cms (µm/N): 0,336
- Vas (l): 12,9798
- Fs (Hz): 65,2
- Qes: 1,210
- Qms: 14,592
- Qts: 1,118
- Crossover Point: 3,5kHz

Club 9632

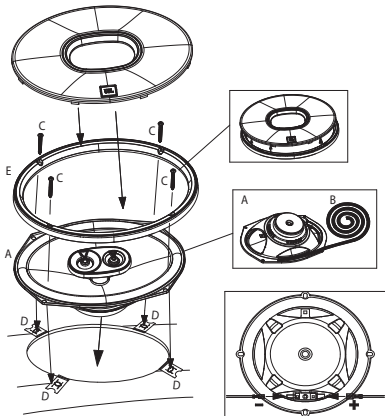
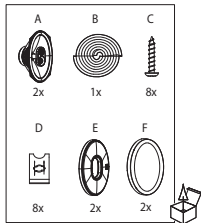

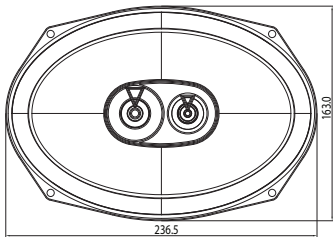
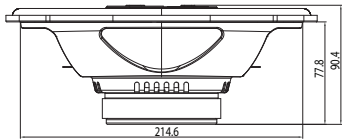

Technische Daten

- Typ: 6" x 9" (152 x 230 mm)-Drei-Wege-Autolautsprecher
- Nennbelastbarkeit: 85 W RMS, 255 W Spitze
- Empfindlichkeit (bei 2,83 V): 93 dB
- Frequenzgang: 50 Hz – 20 kHz
- Nennimpedanz: 3,0 Ohm

Thiele-Small-Parameter

- BL (Tm): 4,063
- DCR (ohms): 2,63
- Mms (g): 23,163
- Sd (cm²): 226,98
- Cms (µm/N): 0,337
- Vas (l): 24,5866
- Fs (Hz): 56,9
- Qes: 1,321
- Qms: 11,751
- Qts: 1,188
- Crossover Point: 3kHz



HARMAN International
Industries, Incorporated
8500 Balboa Boulevard,
Northridge, CA 91329 USA
© 2019 HARMAN International
Industries, Incorporated.
Alle Rechte vorbehalten.

JBL ist eine Marke von HARMAN International Industries, Incorporated, die in den USA und/oder anderen Ländern eingetragen ist.

Änderungen an Merkmalen, Spezifikationen und Aussehen können ohne vorherige Ankündigung erfolgen.