

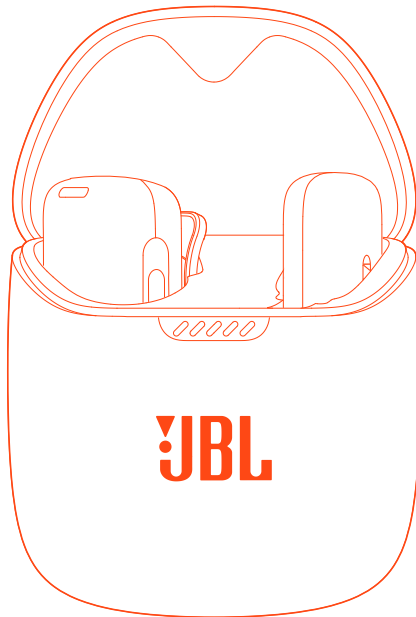

JBL QUANTUM

Stream Wireless



OWNER'S MANUAL

TABLE OF CONTENTS

INTRODUCTION	1
WHAT'S IN THE BOX	2
PRODUCT OVERVIEW	3
Microphone	3
2.4GHz receiver.....	4
Charging case.....	5
GETTING STARTED	6
JBL Headphones app.....	6
First-time setup on PC (for USB-C version only).....	6
First-time setup on Mac (for USB-C version only)	7
How to wear.....	8
USING YOUR MICROPHONE	9
First time use.....	9
Charging.....	9
Power on & connect.....	10
Controls	11
Charge & record (for mobile device only).....	13
Power off.....	14
LED BEHAVIORS	15
PRODUCT SPECIFICATIONS	17
TROUBLESHOOTING	18

INTRODUCTION

Congratulations on your purchase! This manual includes information on the JBL Quantum Stream Wireless. We encourage you to take a few minutes to read this manual, which describes the product and includes step-by-step instructions to help you to set up and get started. Read and understand all the safety instructions before using your product.

If you have any questions about this product or its operation, please contact your retailer or customer service, or visit us at www.JBLQuantum.com

WHAT'S IN THE BOX



01

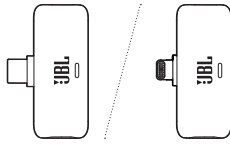

02

03



04



05

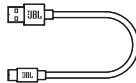

06



07

- 01 Microphone
- 02 2.4GHz receiver (for USB-C version only)
- 03 2.4GHz receiver (for Lightning version only)
- 04 Charging case
- 05 Windscreen
- 06 USB charging cable (USB-A to USB-C)
- 07 QSG, warranty card and safety sheet

PRODUCT OVERVIEW

MICROPHONE

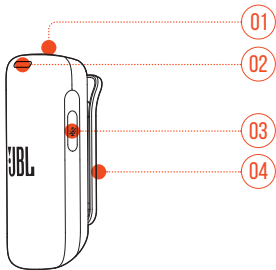

01 Windscreen mount

02 LED indicator

- Indicates the status of 2.4GHz wireless connection.
- Indicates the status of noise cancelling.
- Indicates the status of microphone mute/unmute.
- Indicates the status of microphone battery.

03 Press button

04 Microphone clip

2.4GHz RECEIVER

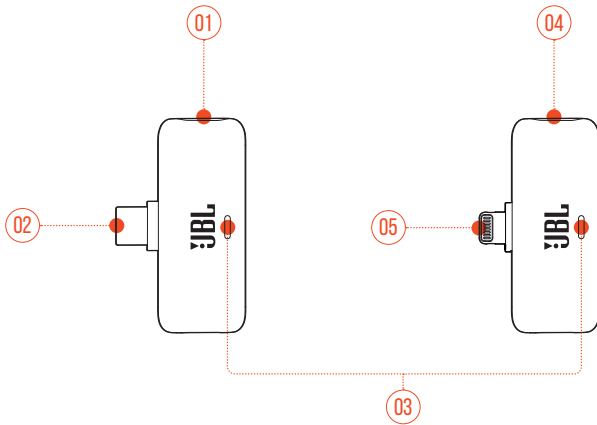

- 01 USB-C port (for USB-C version only)
- 02 USB-C connector (for USB-C version only)
- 03 LED indicator
 - Indicates the status of 2.4GHz wireless connection.
 - Indicates the status of noise cancelling.
 - Indicates the status of microphone mute/unmute.
- 04 Lightning port (for Lightning version only)
- 05 Lightning connector (for Lightning version only)

CHARGING CASE

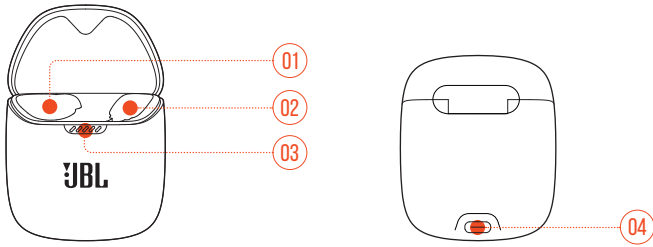

01 Microphone holder

02 2.4GHz receiver holder

03 LED indicator

- Indicates the status of charging case battery.

04 Charging port

GETTING STARTED

JBL HEADPHONES APP

On your mobile device, download the JBL Headphones app from Apple App Store or on Google Play to get even more control and personalization on your JBL Quantum Stream Wireless, such as microphone gain, noise suppression, and sound effects.

FIRST-TIME SETUP ON PC (FOR USB-C VERSION ONLY)

Download **JBL QuantumENGINE** from www.jblquantum.com/engine to gain full access to features on your JBL Quantum Stream Wireless, such as microphone gain, EQ settings, and voice quality meter.

SOFTWARE REQUIREMENTS

Platform: Windows 10 (64 bit only) / Windows 11

500MB of free hard drive space for installation

TIP:

- Always use the latest version of Windows 10 (64 bit) or Windows 11 for the most optimal experience on **JBL QuantumENGINE**.
1. Connect the 2.4GHz receiver to your PC via USB-C connection (See [“Power on & connect”](#)).
 2. Go to **“Sound Settings”** -> **“Sound Control Panel”**.
 3. Under **“Recording”** highlight **“JBL Quantum Stream Wireless”** and select **“Set Default”** -> **“Default Device”**.
 4. Follow the instructions to personalize your sound settings.



FIRST-TIME SETUP ON MAC (FOR USB-C VERSION ONLY)

1. Connect the 2.4GHz receiver to your Mac via USB-C connection (See ["Power on & connect"](#)).
2. Go to **"System Preferences"** -> **"Sound"** -> **"Input"**.
3. Select **"JBL Quantum Stream Wireless"** for sound input.



HOW TO WEAR

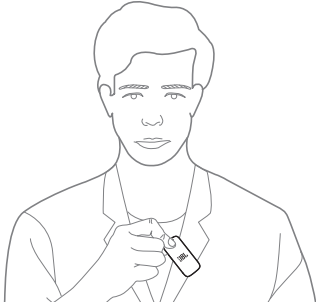

Clip the microphone to your desired position to capture sound from all directions.

TIP:

- Install the windscreen to reduce wind noise while recording.

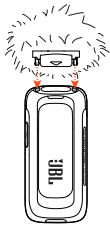

USING YOUR MICROPHONE

FIRST TIME USE

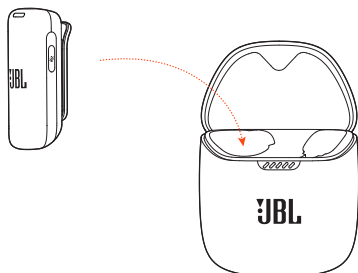

Before first time use, put the microphone into the charging case for activation.

CHARGING

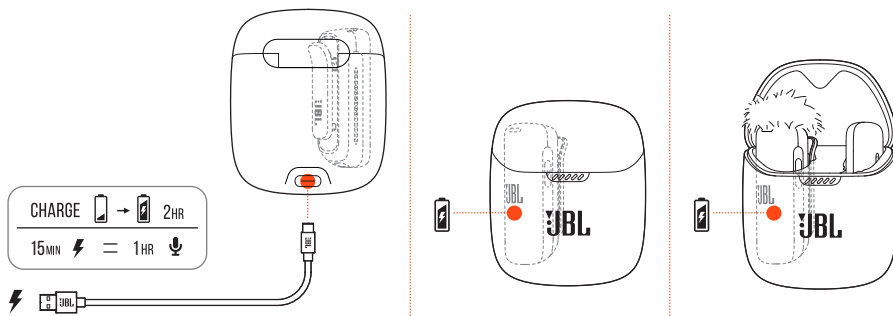

- It takes around two hours to fully charge your microphone through the charging case.
- As a fast charging feature, a fifteen minute charge powers up your microphone for one hour of use.

TIPS:

- During charging, make sure that the charging pins on the microphone and charging case are aligned and in good contact.
- Open the lid to check the battery level of the charging case. See "[LED behaviors](#)". Use the provided USB cable to charge the charging case when necessary.

POWER ON & CONNECT

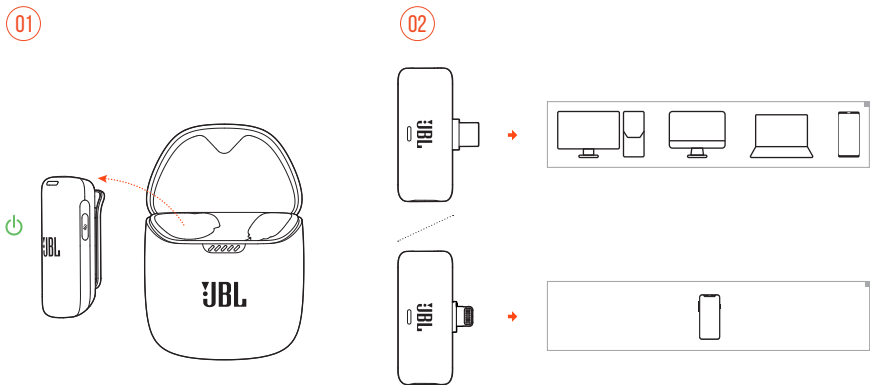

1. Open the lid of the charging case, take out the microphone to power up.
2. Plug the 2.4GHz receiver into your mobile device, PC, or Mac.
 - ↳ The microphone connects to the 2.4GHz receiver automatically.
 - ↳ After successful connection, the LEDs on the microphone and the 2.4GHz receiver turn solid white.

MANUAL PAIRING

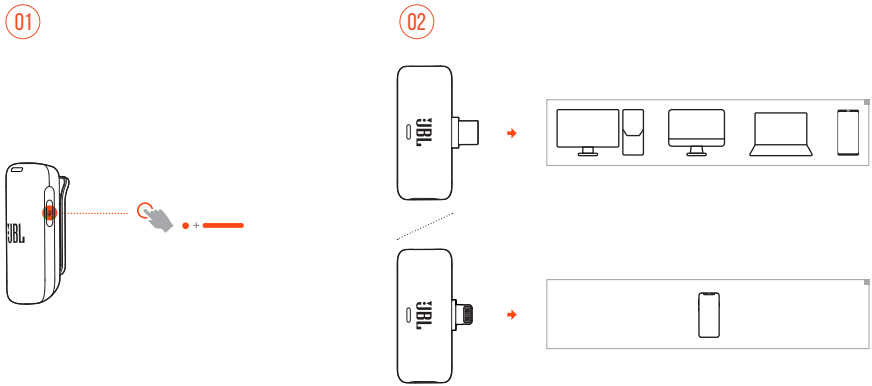

1. Short press then hold the button on the microphone for more than 5 seconds until the LED flashes white quickly.
2. Plug the 2.4GHz receiver into your mobile device, PC, or Mac.
 - ↳ The microphone starts to pair with the 2.4GHz receiver.
 - ↳ After successful connection, the LEDs on the microphone and the 2.4GHz receiver turn solid white.

CONTROLS

PERSONALIZE YOUR SOUND SETTINGS IN JBL HEADPHONES APP

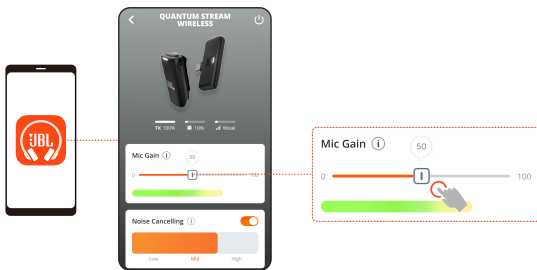

Slide the slider to adjust microphone gain.

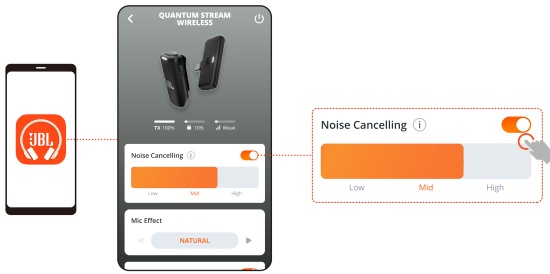

Tap the button to enable noise cancelling, then slide the slider to adjust the noise cancelling level.

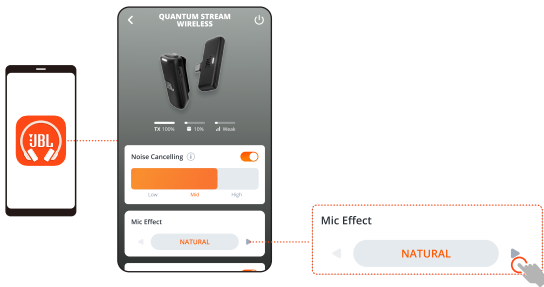

Tap the button to select microphone effect.

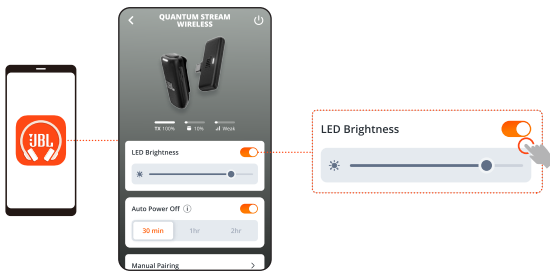

Slide the slider to adjust the LED brightness, or tap the button to turn off the LEDs.

PERSONALIZE YOUR SOUND SETTINGS IN JBL QUANTUMENGINE (FOR USB-C VERSION ONLY)



Download and launch **JBL QuantumENGINE** on your PC to personalize your sound settings, such as microphone volume, noise cancelling, microphone effect and LED brightness.

CHARGE & RECORD (FOR MOBILE DEVICE ONLY)

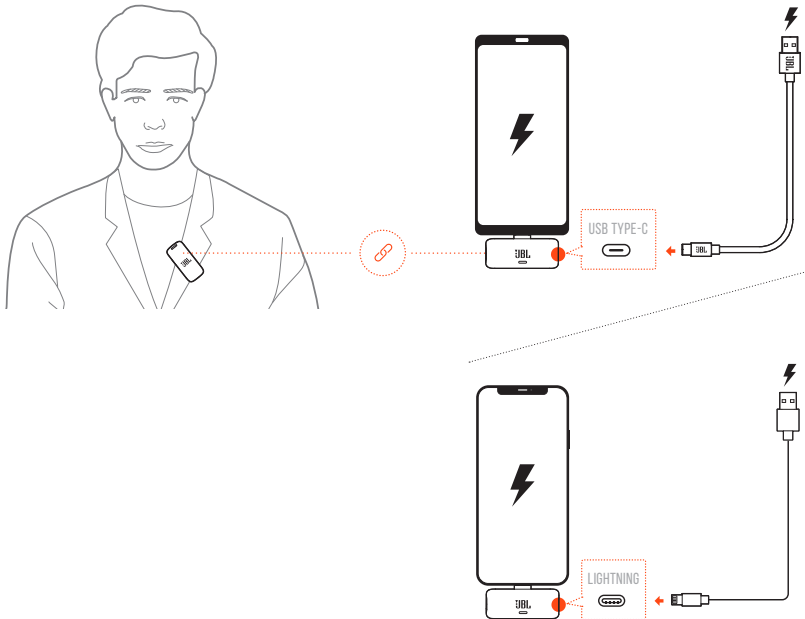

Connect the 2.4GHz receiver with a charging cable to charge your mobile device while recording.

NOTE:

- Lightning to USB-A cable is not included by pack.

POWER OFF

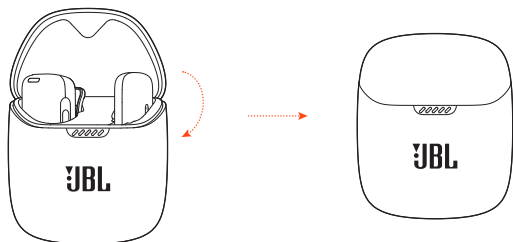

To power off, put the microphone into the charging case and close the lid.

LED BEHAVIORS

LED on microphone:



LED indication	Status	Meaning
	Flashing white quickly	2.4GHz pairing
	Solid white	2.4GHz connected (noise cancelling off)
	Solid pink	2.4GHz connected (noise cancelling on)
	Solid red	Microphone muted
	Flashing red slowly	Low battery
	Flashing white slowly	Charging
	Off	Fully charged

LED on 2.4GHz receiver:

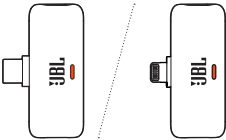

LED indication	Status	Meaning
	Flashing white quickly	2.4GHz pairing
	Solid white	2.4GHz connected (noise cancelling off)
	Solid pink	2.4GHz connected (noise cancelling on)
	Solid red	Microphone muted

LED on charging case:



LED indication	Status	Meaning
☼ ● ●	1 st LED flashing white slowly	Low battery
○ ☼ ●	2 nd or 3 rd LED flashing white slowly	Charging
● ● ●	All three LEDs are off	Fully charged

PRODUCT SPECIFICATIONS

- Model: QUANTUM STREAM WIRELESS
- Power supply: 5 V --- 1 A
- Type: Condensor microphone
- Polar patterns: Omnidirectional
- Frequency response: 20 Hz - 20 kHz
- Sensitivity: -36 dBV/Pa@1 kHz
- Maximum SPL: 100 dB SPL (1 kHz @ 1m) dBu
- Dynamic range: 86 db
- Bit depth: 16 bit
- Sample rate with ENC off: 48 kHz
- Sample rate with ENC on: 16 kHz
- Microphone: 11.2 g / 0.025 lbs
- Dongle (Lightning): 6.6 g / 0.015 lbs
- Dongle (USB-C): 6 g / 0.013 lbs
- Charging case: 47.4 g / 0.104 lbs
- Microphone battery type: Lithium-ion polymer (130 mAh / 3.85 V)
- Charging case battery type: Lithium-ion polymer (550 mAh / 3.7 V)
- Charging time: 2 hrs from empty
- Recording time (ENC on/off): Up to 6 hrs
- Equivalent noise (dBA): 22 dBA
- 2.4GHz Wireless transmitter frequency range: 2.406 GHz - 2.474 GHz
- 2.4GHz Wireless transmitter modulation: GFSK
- 2.4GHz Wireless transmitter power: <10 dBm (EIRP)
- Maximum operation temperature: 45°C

NOTE:

- Technical specifications are subject to change without prior notice.

TROUBLESHOOTING

If you have problems using this product, check the following points before you request service.

NO POWER

- Put the microphone back into the charging case, and then take it out of the charging case to power on again.
- Recharge the microphone and the charging case (see [“Charging”](#)).

2.4GHz PAIRING FAILED BETWEEN MICROPHONE AND 2.4GHz RECEIVER

- Move the microphone closer to the 2.4GHz receiver.
- Pair the microphone with the 2.4GHz receiver again manually (see [“Manual pairing”](#)).

DISTORTED SOUND

- Decrease the microphone gain to an appropriate level.
- Adjust the microphone position so that it is not too close to the sound source.
- Install the windscreen onto the microphone to reduce wind noise during recording.

NO SOUND OR POOR SOUND DURING RECORDING

- Make sure the microphone is unmuted.
- Make sure the microphone and 2.4GHz receiver are connected.
- Move the microphone closer to the sound source.
- Increase the microphone gain and noise cancelling to appropriate levels.
- Make sure you have chosen **JBL Quantum Stream Wireless** as the default device in the sound settings of your PC or Mac (for USB-C version only).

